

PROFILE

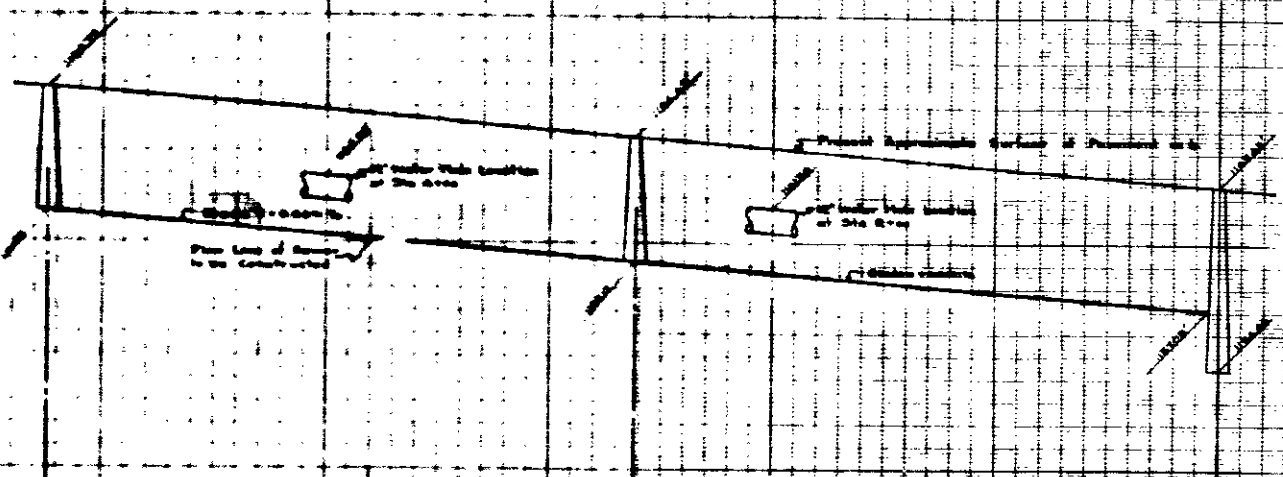

NOTES

- 1) All work shall be done in accordance with applicable provisions of Specifications N.E.R.C. 1954.
- 2) All connecting sewer shall be constructed of 6" vitrified pipe, shall be laid on an upward grade of four percent from the sewer main, and shall extend from the sewer main to the property line.
- 3) 6" x 6" manholes with 4" connecting sewer to be constructed, see above in plan sheet.

PLAN

SCALE 1"=40'

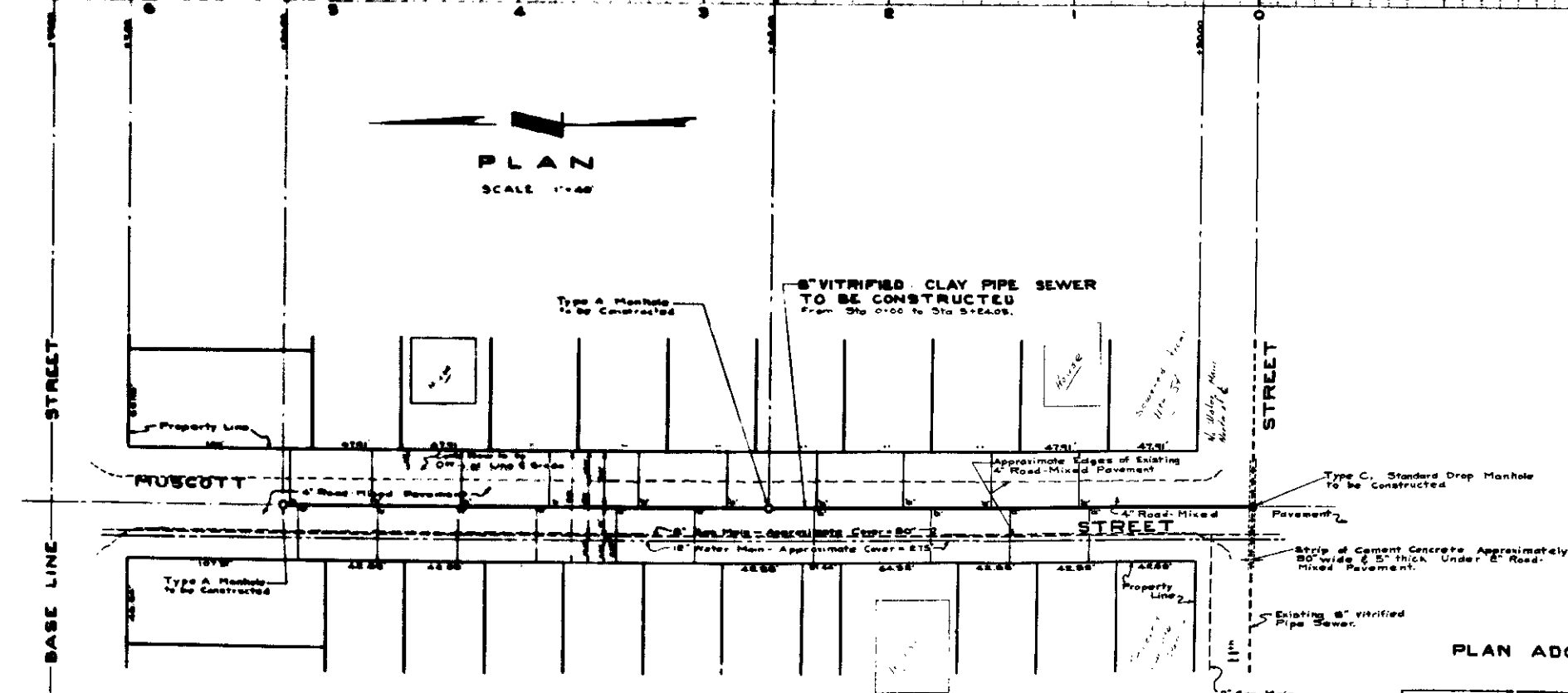

PLAN ADOPTED _____

DEPARTMENT OF ENGINEERING
CITY OF SAN BERNARDINO
MUSCOTT STREET
SEWER PLAN
 From 11th Street to Base Line Street